

THIS PLAN CANCEL AND REPLACE WITH PLAN N: 1006

/ .INDFX:

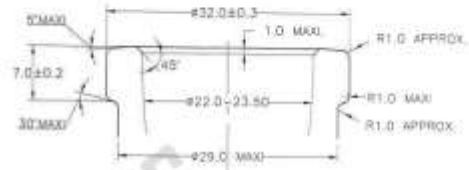

NECK FINISH DETAIL

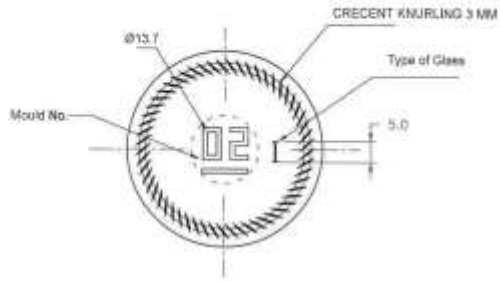
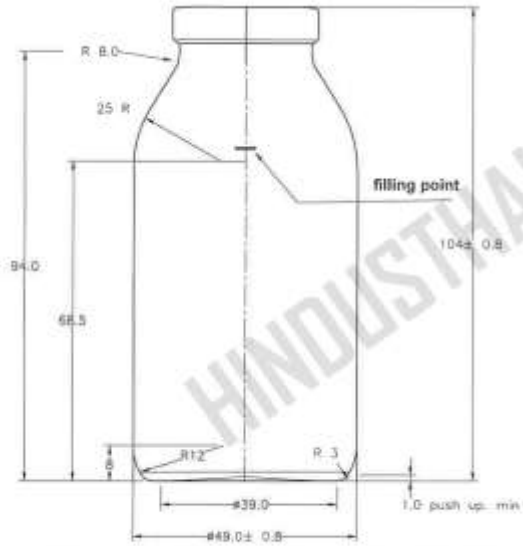

D					
C					
B	0012078		COMPANY NAME AND LOGO CHANGED		
A	19/02/18		Revised Drawing Specifications as per TDS		
REP	DATE	NOTE	MODIFICATIONS	MOULD	INDEX
NECK FINISH: ISO 8536-1			WEIGHT: 92 GRAMS APPROX	MOULD 1006	
Ø CHRNKG: 22.5 ± 0.2mm L&Ls 3mm Deep			BRIMFUL CAPACITY: 128 ML ± 0.5VL		
Ø MIN INTERNAL : 20.5			CAPACITY 100 ML		
<small>THE MATERIAL IS THE PROPERTY OF SCD PHARMA INDIA AND IS TO BE USED ONLY FOR THE PURPOSES SPECIFIED</small>					
		100 ml INFUSION		DATE: 18/11/2018	
				DRAWING NO: CG-MV-1006	

SUIT A PLAN N:

REF: 1006